

PLASMA CUTTING

RPT-Torches suitable for TD 1Torch®

SL60QD®

SL60®

SL100®

SL100SLV®



for:

Esab®

Thermal Dynamics®

Victor®

Quick Disconnect



Manual

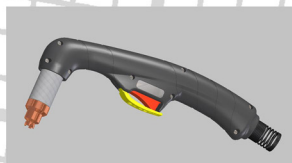

Mechanized



Automated

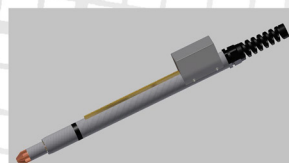

RPT-Torches for TD

RPT-Torches for TD 1TORCH®

Esab® Thermal Dynamics® Victor® SL-60® & SL-100® QD



EASY FIT torches

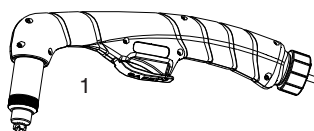

Heavy-Duty torches

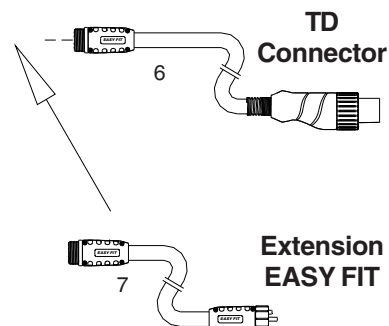
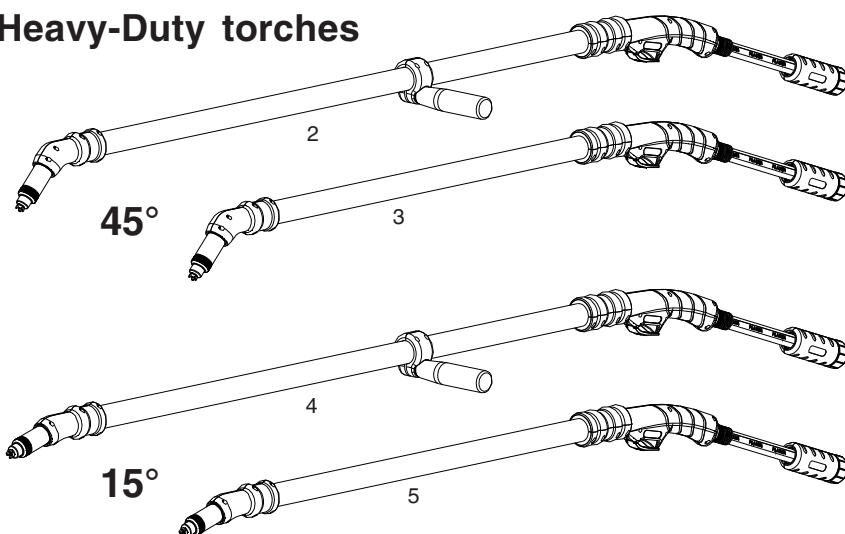

Torch head & leads

Item#	Description	Code#
1	PHE-125 Hand torch head EASY FIT , w/ handle & parts.	05400E
2	PH-125L 45° Hand Torch Heavy-Duty 130cm (52"), EASY FIT connection	05431LE
3	PH-125L 45° Hand Torch Heavy-Duty 80cm (31"), EASY FIT connection	05431LF
4	PH-125L 15° Hand Torch Heavy-Duty 130cm (52"), EASY FIT connection	05431LA
5	PH-125L 15° Hand Torch Heavy-Duty 80cm (31"), EASY FIT connection	05431LB
6	Lead assembly 7.5m, Female EASY FIT 6pins - Male TD connection Lead assembly 15m, Female EASY FIT 6pins - Male TD connection	05286FX-TD 05288FX-TD
7	Extension, 6m (20 ft), complete with EASY FIT , Coaxial Cable Extension, 7.5m (25 ft), complete with EASY FIT , Coaxial Cable Extension, 12m (40 ft), complete with EASY FIT , Coaxial Cable Extension, 15m (50 ft), complete with EASY FIT , Coaxial Cable	05285FX 05286FX 05287FX 05288FX

RPT-Torches for TD 1TORCH® Esab® Thermal Dynamics® Victor® SL-60® & SL-100® Manual cutting

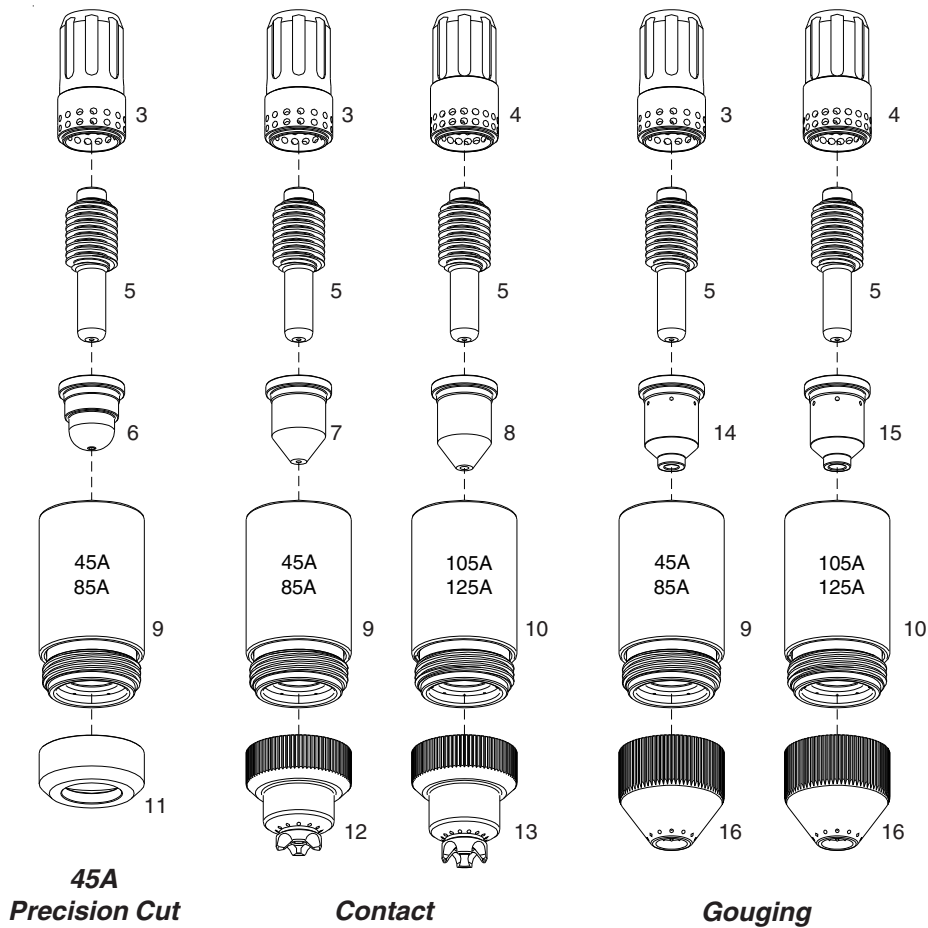
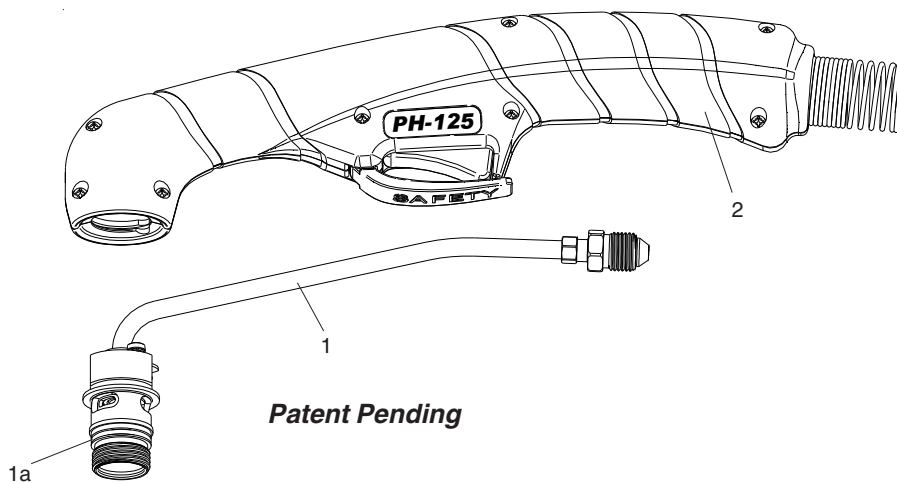

RPT-Torches for TD 1TORCH®

Esab® Thermal Dynamics® Victor® SL-60® & SL-100®

Replacement Parts

Torch parts

Item	Description	Code
1	PH-125 75° Hand Torch Head Patent Pending	05400
1a	O-Ring	03700.60
2	Handle PH-125 75° complete with parts	05405
3	Swirl ring, 45-85A	60042E
	Swirl ring, 45-85A Maximum Life	60042
4	Swirl ring, 105-125A	60040E
	Swirl ring, 105-125A Maximum Life	60040
5	Electrode, 45-125A	52677
	Electrode, 45-125A, BiMetal	52677BM
6	Tip, Cutting, 45A Precision Cut	51415
7	Tip, Cutting, 45A	51416
	Tip, Cutting, 65A	51417
	Tip, Cutting, 85A	51418
8	Tip, Cutting, 105A	51419
	Tip, Cutting, 125A	51419.16
9	Shield Cup Body, 45-85A	60309AV
10	Shield Cup Body, 105-125A	60309BV
11	Deflector, 45A Precision Cut	51928
12	Shield Cap, Hand, 45-85A	51921
13	Shield Cap, Hand, 105-125A	51926
14	Tip, Gouging, 65-85A	51417G
15	Tip, Gouging, 105A	51418G
	Tip, Gouging, 125A	51419G
16	Shield Cap, Gouging	51927G

Torches & Leads

*	PH-125 75° (SL-100) Hand Torch 6m (20 ft)	05421CX-TD
*	PH-125 75° (SL-100) Hand Torch 15m (50 ft)	05426CX-TD
*	PH-125 75° (SL-100) Lead Assembly, Hand, 6m (20 ft) Length	05481CX-TD
*	PH-125 75° (SL-100) Lead Assembly, Hand, 15m (50 ft) Length	05486CX-TD

Accessories

N/S	Circle Cutting Attachment	51865
17	BEVEL TOOL	51880

Bevel Tool

Patent pending

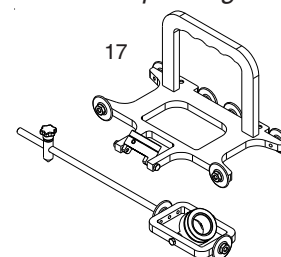

Air Filter

AT-1000

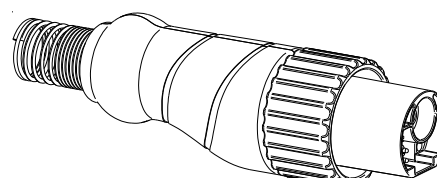
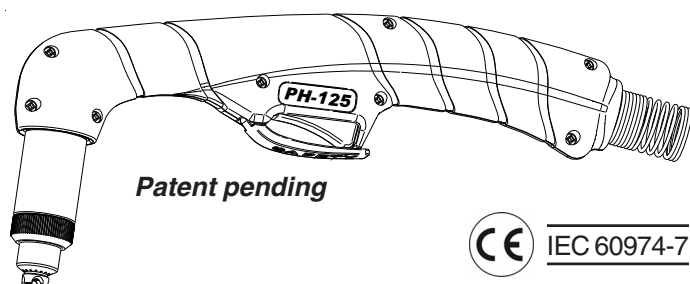

RPT-Torches for TD 1TORCH® Esab® Thermal Dynamics® Victor® SL-60® & SL-100® SLV Mechanized & Automated

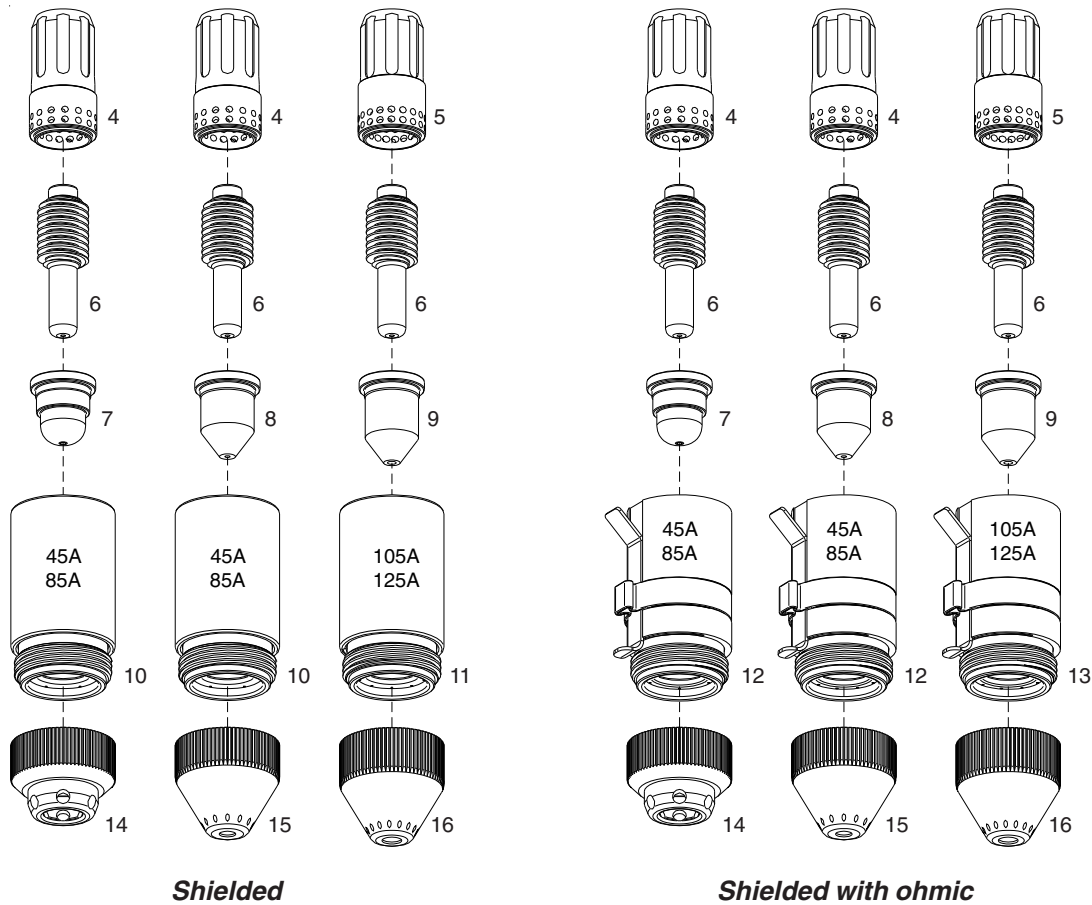
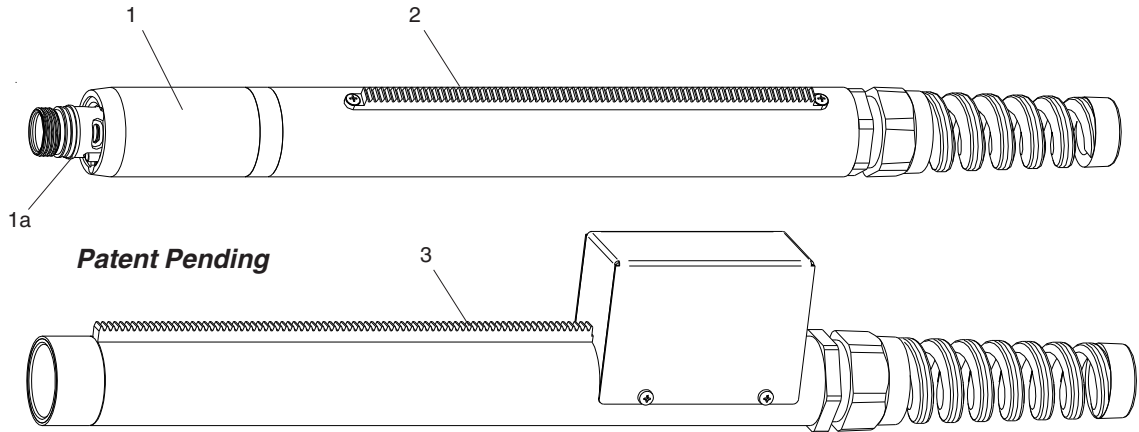

RPT-Torches for TD 1TORCH®

Esab® Thermal Dynamics® Victor® SL-60® & SL-100®

Replacement Parts

Torch parts

Item	Description	Code
1	PM-125 Machine Torch Head <i>Patent Pending</i>	05410
1a	O-Ring	03700.60
2	Fiberglass Positioning Tube With Rack	07219
3	Fiberglass Positioning Tube With Rack & Solenoid "SLV"	07212
4	Swirl ring, 45-85A	60042E
	Swirl ring, 45-85A Maximum Life	60042
5	Swirl ring, 105-125A	60040E
	Swirl ring, 105-125A Maximum Life	60040
6	Electrode, 45-125A	52677
	Electrode, 45-125A, BiMetal	52677BM
7	Tip, Cutting, 45A Precision Cut	51415
8	Tip, Cutting, 45A	51416
	Tip, Cutting, 65A	51417
	Tip, Cutting, 85A	51418
9	Tip, Cutting, 105A	51419
	Tip, Cutting, 125A	51419.16
10	Shield Cup Body, 45-85A	60309AV
11	Shield Cup Body, 105-125A	60309BV
12	Shield Cup Body, 45-85A Ohmic	60309HA
13	Shield Cup Body, 105-125A Ohmic	60309HB
14	Shield Cap, 45A Precision Cut	51929
15	Shield Cap, Machine, 45-85A	51922
16	Shield Cap, Machine, 105-125A	51927

Torches & Leads

*	PM-125 (SL-100) Machine Torch 7.5m (25 ft)	05431CX-TD
*	PM-125 (SL-100) Machine Torch 15m (50 ft)	05436CX-TD
*	PM-125 (SL-100) Lead Assembly, Machine, 7.5m (25 ft) Length	05491CX-TD
*	PM-125 (SL-100) Lead Assembly, Machine, 15m (50 ft) Length	05496CX-TD

**Air Filter
AT-1000**



Patent pending

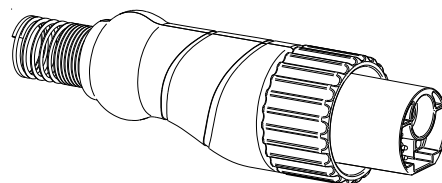
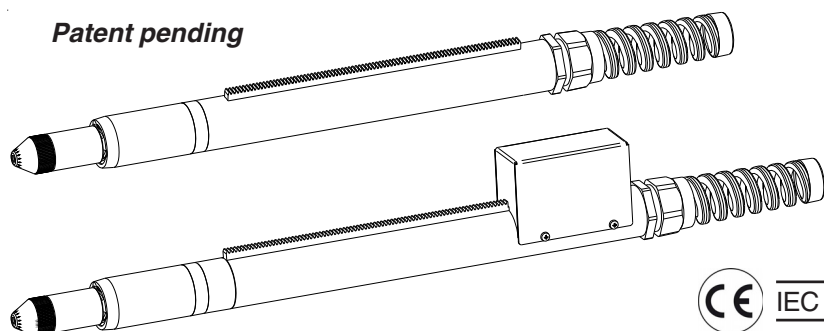

AIR FILTER AT1000

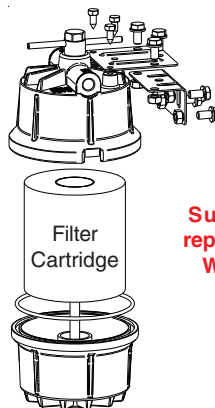

Air Filter Complete Code: 50500

Packaging:

Air Filter AT1000

Code: 50500-12

Carton Box: 12 Filters

Dimensions: 11" x 16.5" x h. 17.3"
(cm 28 x 42 x h. 44)

Weight: 43 lbs (19.5 kg)

Filter Cartridge

Code: 50505-8

Carton Box: 8 Cartridges

Dimensions: 8.58" x 8.58" x h. 9.61"
(cm 21.8 x 21.8 x h. 24.4)

Weight: 4.2 lbs (1.9 kg)

Code: 50505-48

Master Box: 8x6=48 Cartridges

Dimensions: 17.72" x 26.38" x h. 10.43"
(cm 45 x 67 x h. 26.5)

Weight: 26.7 lbs (12.1 kg)

"AT 1000" is the perfect solution to the problems created by the contamination of the compressed air used in many plasma cutting systems.

It eliminates "sputter" caused by moisture and oil from compressed air lines.

It extends the electrode and nozzle life, with obvious benefits to the cut quality.

Designed to remove aerosol oil and moisture, "AT 1000" is a real benefit, entrapping particles as small as .01 microns inches.

With "AT 1000" torches last longer. Without this filter, at the end of this cutting session, inside the torch and torch head you have left condensed moisture, that can cause a short-circuit, with consequent rise of costs coming from the replacement of the torch head and the needed time to realize this operation.

"AT 1000" can filter up to 1250 liters a minute without reduction in pressure.

It's recommended to replace the filter cartridge every 5 to 7 days (max).

It's also very suitable for painters and use of pneumatic tools.

Our excellent knowhow in the production of plasma cutting torches and the consequent problems of air contaminant brought us to create the "AT 1000" being very effective and important for users of plasma cutting systems.

BEVEL TOOL

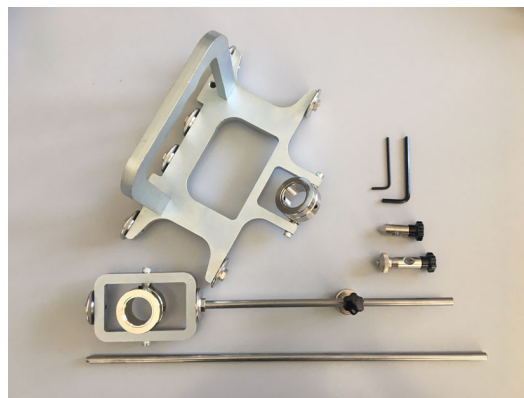

Code	Description
51880	PMAX 1000/1250/1650® - PMAX 45/65/85/105® - TEC.MO.® PT80 - TH70 - TH125 - PH70 - PH125
51886	PMAX 125® - TEC.MO.® TH160 - PH160

CNC Plasma Water Table

Ask for more specific information



- Eliminates the need for the suction hood
- Preserve the cutting table technical and mobile parts from rust corrosion
- Solves the problem of rust in the finished piece
- Catches 98 % of fumes and dust
- Absorbs the majority of sparks

BIOLOGICUT Water Table fluid



Code	Description
50005	BIOLOGICUT WATER TABLE FLUID (5 LT.) / 1 BOX X 4 PIECES / DIMENSIONS: 44x30xH30 (Kg. 20)

TEC.MO.
=

Quality
Technology
Innovation